

Reciprocator EHR 9200

Electrical vertical reciprocator with toothed belt drive

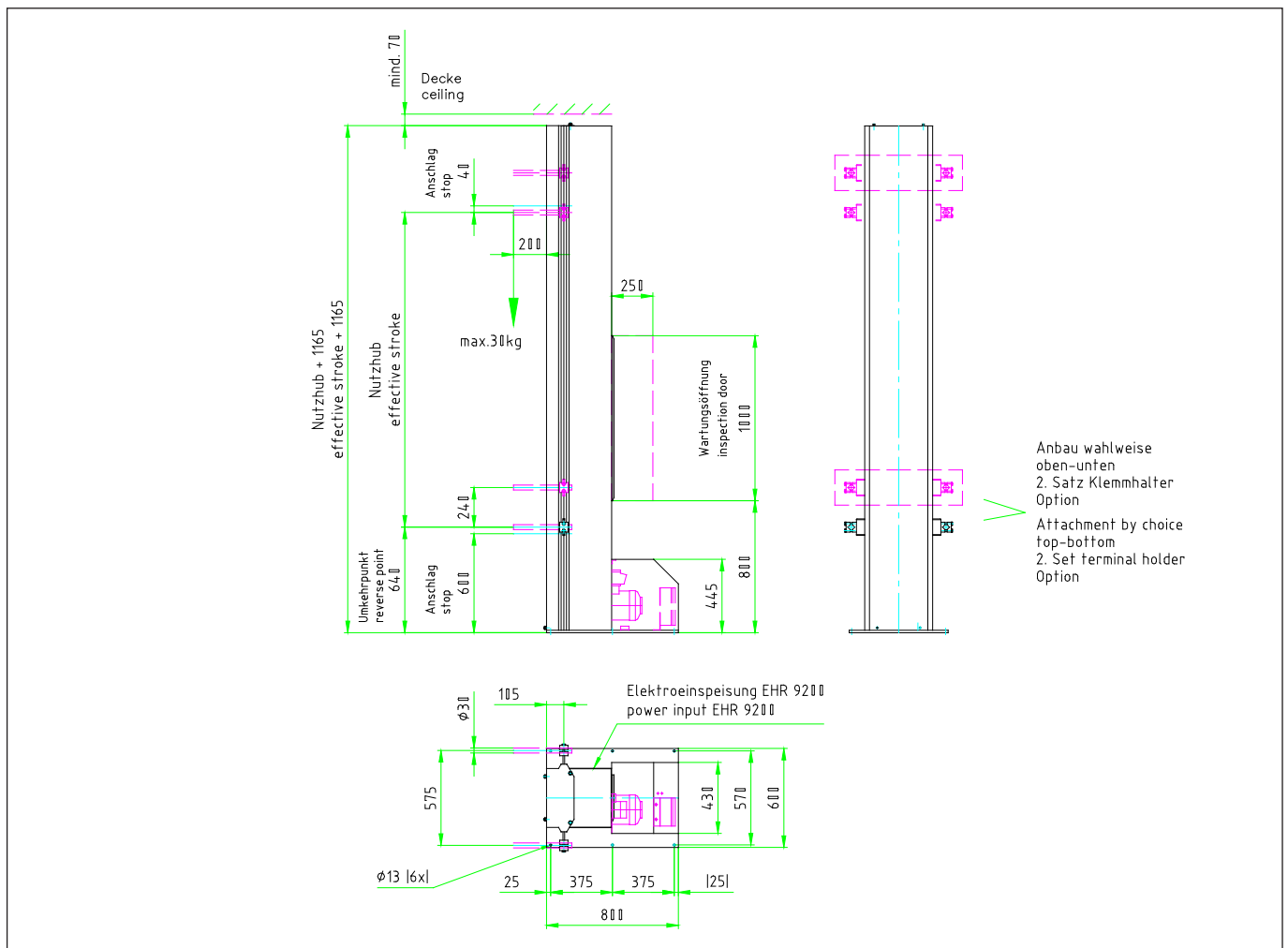

In addition to the mechanical parts Reiter offers the perfectly matched control system for reciprocators. The basic version ensures by closed loop control the accurate and reproducible positioning and speed with various loads and speeds.

The controls range from simple stand-alone-controls for reversing points and speed to freely programmable speed profiles depending on work piece dimensions for

complex tasks. The integration and communication with the application technology, additional axes and functions are further options.

Our control department offers state of the art control solutions for height, gap controls in two and three dimensions depending on the project requirements.



INNOVATIVE RECIPROCATOR TECHNOLOGY BY THE SPECIALIST.

Technical Data

Vertical reciprocator EHR 9200 with toothed belt drive

Stroke length:	500 - 3000 mm
Speed:	7 - 50 m/min.
Load:	30 kg, at 200 mm distance from front
Electrical connection:	240/400 V, 50 - 60 Hz
Rated power:	1,5 kW
Protection classification:	EHR, EVK IP 4, (Standard), zone 1 + 2 optional , control IP 54
Weight:	265 - 440 kg

Features

- Rigid stroke tower design with no vibration
- Smooth movement by twelve rollers attached to carriage
- Drive system with worm gear box and AC motor
- Balance weight carriage to counter load
- Safety limit switches top /bottom with cushioned hard stops
- Protective covers with stripe to avoid dirt and dust inside
- Maintenance friendly design
- Special versions up to 7,5 m stroke
- ATEX version for zone 1 (optional)
- Horizontal versions

Accessories

- In/out positioning unit
- 2 and 3 axes, electrically or pneumatically
- Hanging version
- Roller set with brakes
- Cable drag chains
- Swivelling axes
- Gun holder